

VALLEY CHRISTIAN ACADEMY  
ACCESSIBILITY IMPROVEMENTS  
301 W. WHYTE AVENUE, ROSEVILLE, CA  
7400 WHYTE AVENUE, CITRUS HEIGHTS, CA

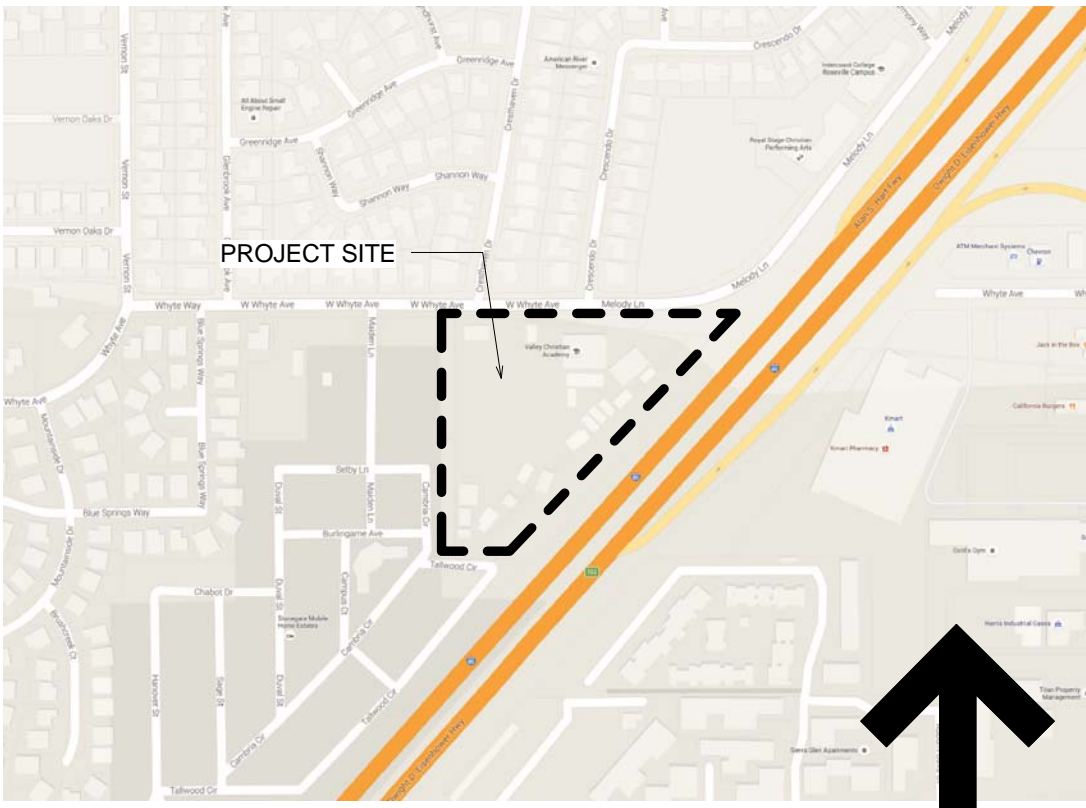

VICINITY MAP

12" = 1'-0"

1

EXTERIOR

1. PROVIDE ACCESSIBLE PATH OF TRAVEL TO CLASSROOMS 1, 2, 3, 4, 5, 6, 7, 8, 9, 10, 11A, 11B, 12, 13, 14, 15, AND WEIGHT ROOM
2. PROVIDE ACCESSIBLE RAMPS AND STAIRS TO CLASSROOMS NOTED ABOVE
3. PROVIDE NEW ACCESSIBLE PATHS OR RECONSTRUCT EXISTING PATHS TO MEET ACCESSIBILITY REQUIREMENTS
4. REMODEL ACCESSIBLE PARKING AND PROVIDE REQUIRED SIGNAGE

ARCHITECTURAL

- |      |                     |
|------|---------------------|
| A0.1 | TITLE SHEET         |
| A1.1 | SITE PLAN - NORTH   |
| A1.2 | SITE PLAN - SOUTH   |
| A5.1 | ACCESSIBLTY DETAILS |
| A5.2 | ACCESSIBLTY DETAILS |

SCOPE OF WORK

1/4" = 1'-0"

6

BUILDING OCCUPANCY	E
CONSTRUCTION TYPE	V-B
FIRE SPRINKLERS	NO

BUILDING AREAS		
CLASSROOM #3	24' x 40'	960 S.F.
CLASSROOM #4	24' x 40'	960 S.F.
CLASSROOM #5	24' x 40'	960 S.F.
CLASSROOM #7	28' x 50'	1,400 S.F.
WEIGHT ROOM	12' x 56'	672 S.F.
CLASSROOM #9	20' x 32'	640 S.F.
CLASSROOM #10	24' x 40'	960 S.F.
CLASSROOM #11A & 11B	40' x 48'	1,920 S.F.

TOTAL BUILDING AREA 8,472 S.F.

TOTAL PARKING PROVIDED 97 STALLS

ACCESSIBLE PARKING REQUIRED 4, INCLUDING 1 VAN ACCESSIBLE

ACCESSIBLE PARKING PROVIDED 5 STALLS + 2 VAN

PROJECT SUMMARY

12" = 1'-0"

3

OWNER:  
VALLEY CHRISTIAN ACADEMY  
301 W. WHYTE AVENUE  
CITRUS HEIGHTS, CA 95678  
(916) 728-5000  
[lccapslor@surrewest.net](mailto:lccapslor@surrewest.net)

ARCHITECT:  
MILBURN ARCHITECTURE  
8903 QUARTZITE CIRCLE  
GRANITE BAY, CA 95746  
(916) 622-3232 (OFFICE)  
(877) 780-1858 (FAX)  
[johnm@milburnarch.com](mailto:johnm@milburnarch.com)

SURVEYOR:  
ROBERT SPENCER, P.E.  
15018 PAMMY WAY  
GRASS VALLEY, CA 95949  
(916) 439-6216  
[golengineer@gmail.com](mailto:golengineer@gmail.com)

PROJECT DIRECTORY

12" = 1'-0"

4

MILBURN  
Architecture, Inc  
8903 QUARTZITE CIRCLE, GRANITE BAY, CA 95746  
PH: 916 622-3232 FAX: 877 780-1858

PROJECT

VALLEY CHRISTIAN ACADEMY  
301 W. WHYTE AVENUE  
ROSEVILLE, CA 95678

CLIENT

TABERNACLE BAPTIST CHURCH

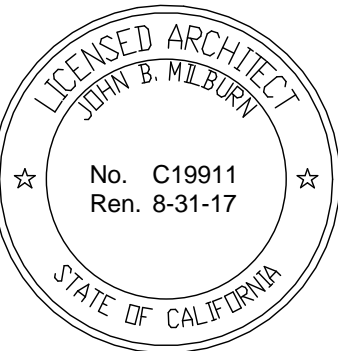

No.	Description	Date
1	Planning Revision	5-9-16

THIS DRAWING EMBODIES DESIGNS, IDEAS, PLANS, ARRANGEMENTS, AND SPECIFICATIONS WHICH ARE PROPRIETARY TO MILBURN ARCHITECTURE, INC., AND WHICH WERE DESIGNED, CREATED, EVOLVED, AND DEVELOPED FOR THE USE SOLELY IN CONNECTION WITH THE SPECIFIED PROJECT. NO TRANSFER OF ANY RIGHTS THERE TO IS INTENDED OR EFFECTED BY DELIVERY THEREOF, AND EXCEPT UPON WRITTEN PERMISSION OF MILBURN ARCHITECTURE, INC., THIS DRAWING IS NOT TO BE REPRODUCED OR COPIED IN WHOLE OR PART, OR USED IN THE FABRICATION OR CONSTRUCTION OF BUILDINGS, STRUCTURES, OR ANY PORTIONS THEREOF FOR OTHER THAN THE SPECIFIED PROJECT.

COPYRIGHT 2015 MILBURN ARCHITECTURE, INCORPORATED

TITLE SHEET

JOB NO : 1346

DATE : 4-10-16

DRAWN : JBM

CHECK : JBM

SHEET NO.

A0.1

OF

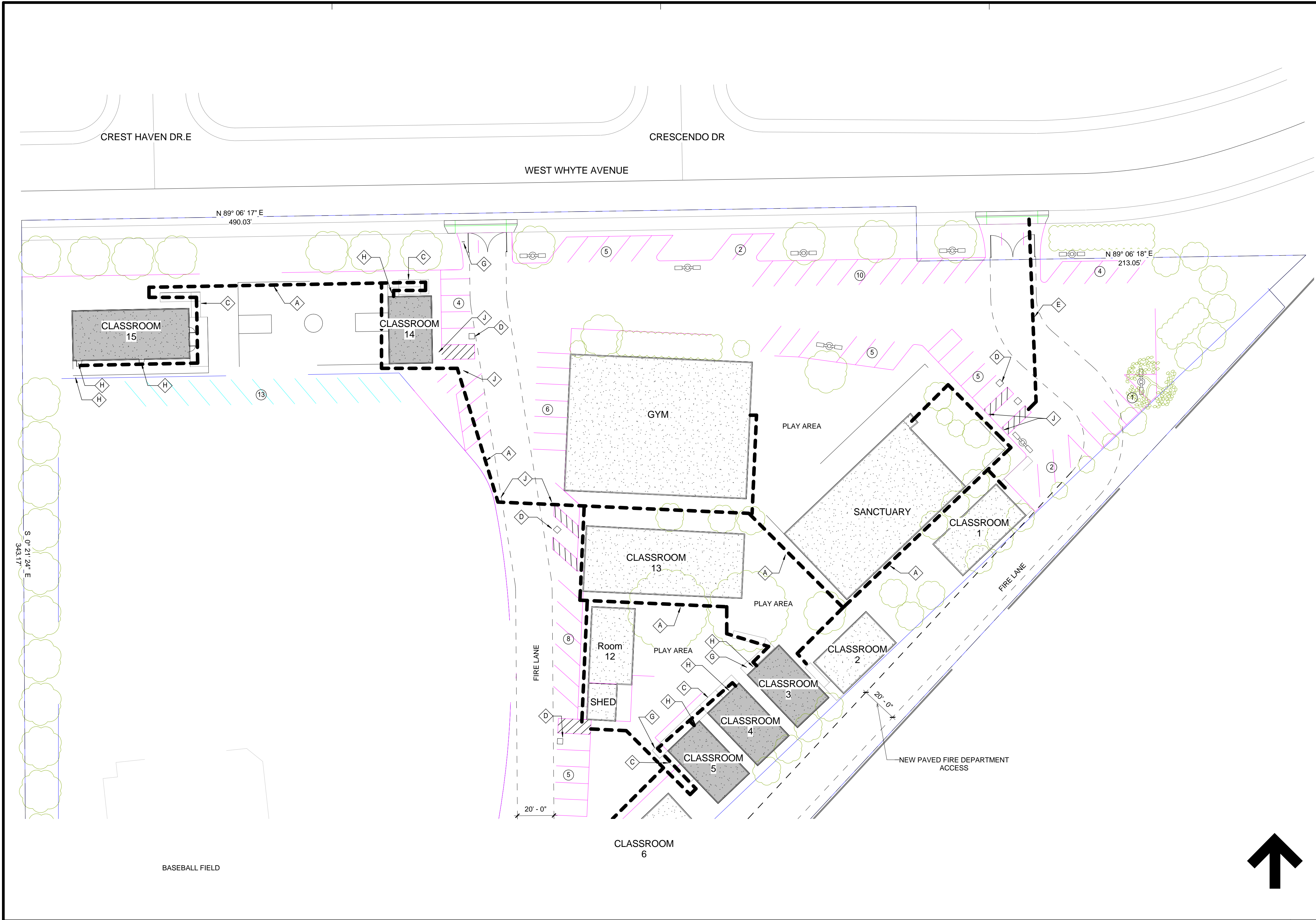

- LEGEND**
- KEYNOTE
  - PARKING COUNT
  - BUILDINGS TO BE ACCESSIBLE
  - ACCESSIBLE PATH OF TRAVEL

**MILBURN**

Architecture, Inc

8903 QUARTZITE CIRCLE, GRANITE BAY, CA 95746

PH: 916 622-3232 FAX: 877 780-1858

PROJECT

VALLEY CHRISTIAN ACADEMY  
301 W. WHYTE AVENUE  
ROSEVILLE, CA

CLIENT

TABERNACLE BAPTIST CHURCH

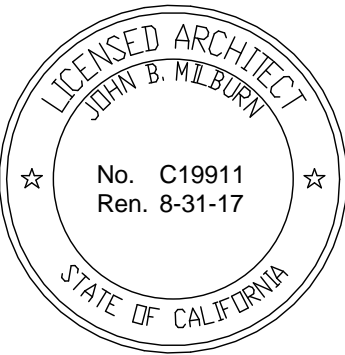

No.	Description	Date

THIS DRAWING EMBODIES DESIGNS, IDEAS, PLANS, ARRANGEMENTS, AND SPECIFICATIONS WHICH ARE PROPRIETARY TO MILBURN ARCHITECTURE, INC., AND WHICH WERE DESIGNED, CREATED, EVOLVED, AND DEVELOPED FOR THE USE SOLELY IN CONNECTION WITH THE SPECIFIED PROJECT. NO TRANSFER OF ANY RIGHTS THERETO IS INTENDED OR EFFECTED BY DELIVERY THEREOF, AND EXCEPT UPON WRITTEN PERMISSION OF MILBURN ARCHITECTURE, INC. THIS DRAWING IS NOT TO BE REPRODUCED OR COPIED IN WHOLE OR PART, OR USED IN THE FABRICATION OR CONSTRUCTION OF BUILDINGS, STRUCTURES, OR ANY PORTIONS THEREOF FOR OTHER THAN THE SPECIFIED PROJECT.

COPYRIGHT 2015 MILBURN ARCHITECTURE, INCORPORATED

**SITE PLAN - NORTH**

JOB NO : 1346

DATE : 4-10-16

DRAWN : JBM

CHECK : Checker

SHEET NO.

**A1.1**

OF

**SITE PLAN - NORTH**

1" = 30'-0"

7

- A** ACCESSIBLE PATH OF TRAVEL
- (CBC 11B-403.5.1) MINIMUM CLEAR WIDTH : 48"
- (CBC 11B-403.3) MAXIMUM SLOPE : 1:20
- (CBC 11B-403.3) MAXIMUM CROSS SLOPE : 1:48
- (CBC 11B-302.1) WALKING SURFACE : STABLE, FIRM AND SLIP RESISTANT
- (11B-403.7) CONTINUOUS GRADIENT : PROVIDE RESTING AREAS 60" LONG AT 400' INTERVALS MAXIMUM
- (11B-403.5.2) CLEAR WIDTH AT TURNS : 180 DEGREE TURNS, 60" MINIMUM WIDTH
- FOR CHANGES LESS THAN 1/2" SEE 3 / A5.1
- FOR CHANGES MORE THAN 1/2" SEE 10 / A5.2
- B** CURB RAMP, SEE 13 / A5.1
- C** ACCESSIBLE RAMP, SEE 10 / A5.2
- D** ACCESSIBLE PARKING, SEE 2 / A5.1
- E** ACCESSIBLE PATH FROM PUBLIC WAY, SEE 'A' ABOVE
- F** PARKING LOT SIGNAGE, SEE 9 / A5.1
- G** STAIRS, SEE 8 / A5.1
- H** EXTERIOR DOORS, SEE 4 / A5.1
- J** PROVIDE DETECTABLE WARNING AT ACCESSIBLE PATHS THAT ARE AT THE SAME GRADE AS THE VEHICULAR WAY, SEE 5 / A5.1



**KEY PLAN**

1" = 160'-0"

4



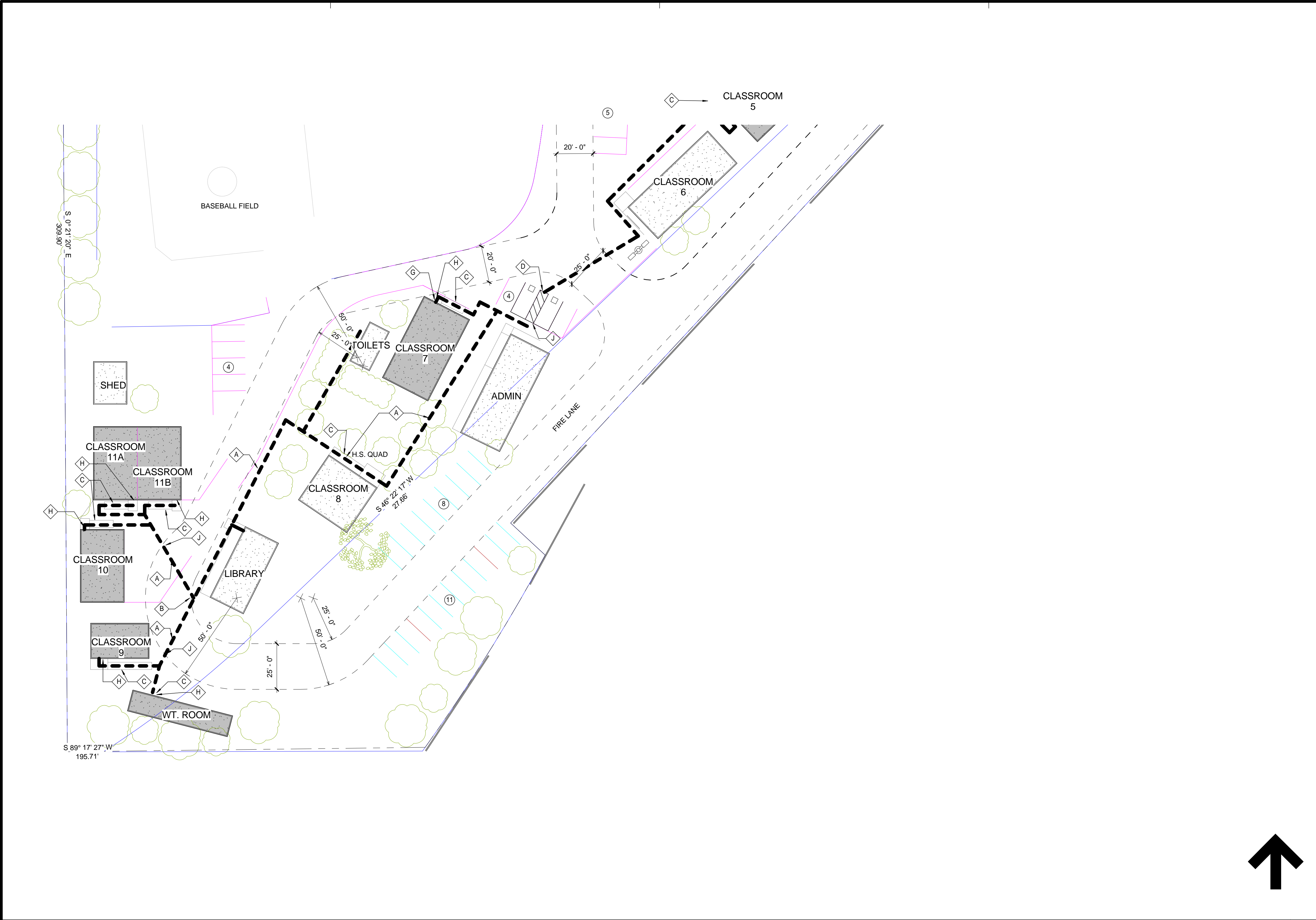

SITE PLAN - SOUTH

1" = 30'-0" 7

- A** ACCESSIBLE PATH OF TRAVEL  
(CBC 11B-403.5.1) MINIMUM CLEAR WIDTH : 48"  
(CBC 11B-403.3) MAXIMUM SLOPE : 1:20  
(CBC 11B-403.3) MAXIMUM CROSS SLOPE : 1:48  
(CBC 11B-302.1) WALKING SURFACE : STABLE, FIRM AND SLIP RESISTANT  
(11B-403.7) CONTINUOUS GRADIENT : PROVIDE RESTING AREAS 60' LONG AT 400' INTERVALS MAXIMUM  
(11B-403.5.2) CLEAR WIDTH AT TURNS : 180 DEGREE TURNS, 60' MINIMUM WIDTH  
GRADE CHANGES : FOR CHANGES LESS THAN 1/2" SEE 3 / A5.1  
FOR CHANGES MORE THAN 1/2" SEE 10 / A5.2
- B** CURB RAMP, SEE 13 / A5.1
- C** ACCESSIBLE RAMP, SEE 10 / A5.2
- D** ACCESSIBLE PARKING, SEE 2 / A5.1
- E** ACCESSIBLE PATH FROM PUBLIC WAY, SEE 'A' ABOVE
- F** PARKING LOT SIGNAGE, SEE 9 / A5.1
- G** STAIRS, SEE 8 / A5.1
- H** EXTERIOR DOORS, SEE 4 / A5.1
- J** PROVIDE DETECTABLE WARNING AT ACCESSIBLE PATHS THAT ARE AT THE SAME GRADE AS THE VEHICULAR WAY, SEE 5 / A5.1

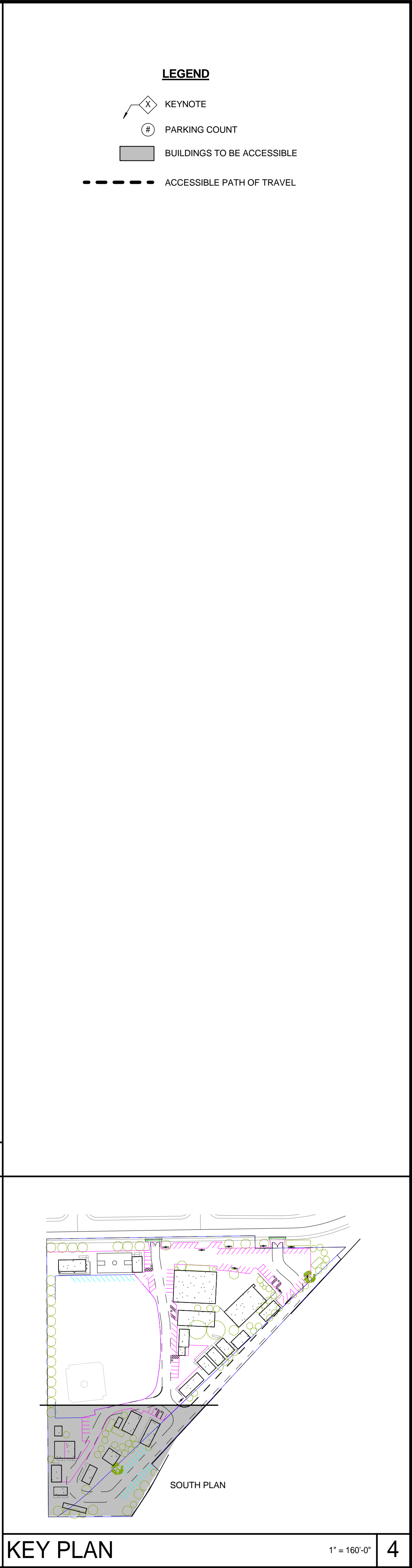

**MILBURN**

Architecture, Inc

8903 QUARTZITE CIRCLE, GRANITE BAY, CA 95746  
PH: 916 622-3232 FAX: 877 780-1858

PROJECT

VALLEY CHRISTIAN ACADEMY  
301 W. WHYTE AVENUE  
ROSEVILLE, CA

CLIENT

TABERNACLE BAPTIST CHURCH

LICENSED ARCHITECT  
JOHN T. MILBURN  
No. C19911  
Ren. 8-31-17  
STATE OF CALIFORNIA

No.	Description	Date

THIS DRAWING EMBODIES DESIGN, IDEAS, PLANS, ARRANGEMENTS, AND SPECIFICATIONS WHICH ARE PROPRIETARY TO MILBURN ARCHITECTURE, INC., AND WHICH WERE DESIGNED, CREATED, EVOLVED, AND DEVELOPED FOR THE USE SOLELY IN CONNECTION WITH THE SPECIFIED PROJECT. NO TRANSFER OF ANY RIGHTS THERE TO IS INTENDED OR EFFECTED BY DELIVERY THEREOF, AND EXCEPT UPON WRITTEN PERMISSION OF MILBURN ARCHITECTURE, INC., THIS DRAWING IS NOT TO BE REPRODUCED OR COPIED IN WHOLE OR PART, OR USED IN THE FABRICATION OR CONSTRUCTION OF BUILDINGS, STRUCTURES, OR ANY PORTIONS THEREOF FOR OTHER THAN THE SPECIFIED PROJECT.

COPYRIGHT 2015 MILBURN ARCHITECTURE, INCORPORATED

**SITE PLAN - SOUTH**

JOB NO : 1346	SHEET NO.
DATE : 4-10-16	<b>A1.2</b>
DRAWN : Author	OF
CHECK : Checker	